

4 FT. ALUMINUM SLAT BENCH SPECIFICATIONS

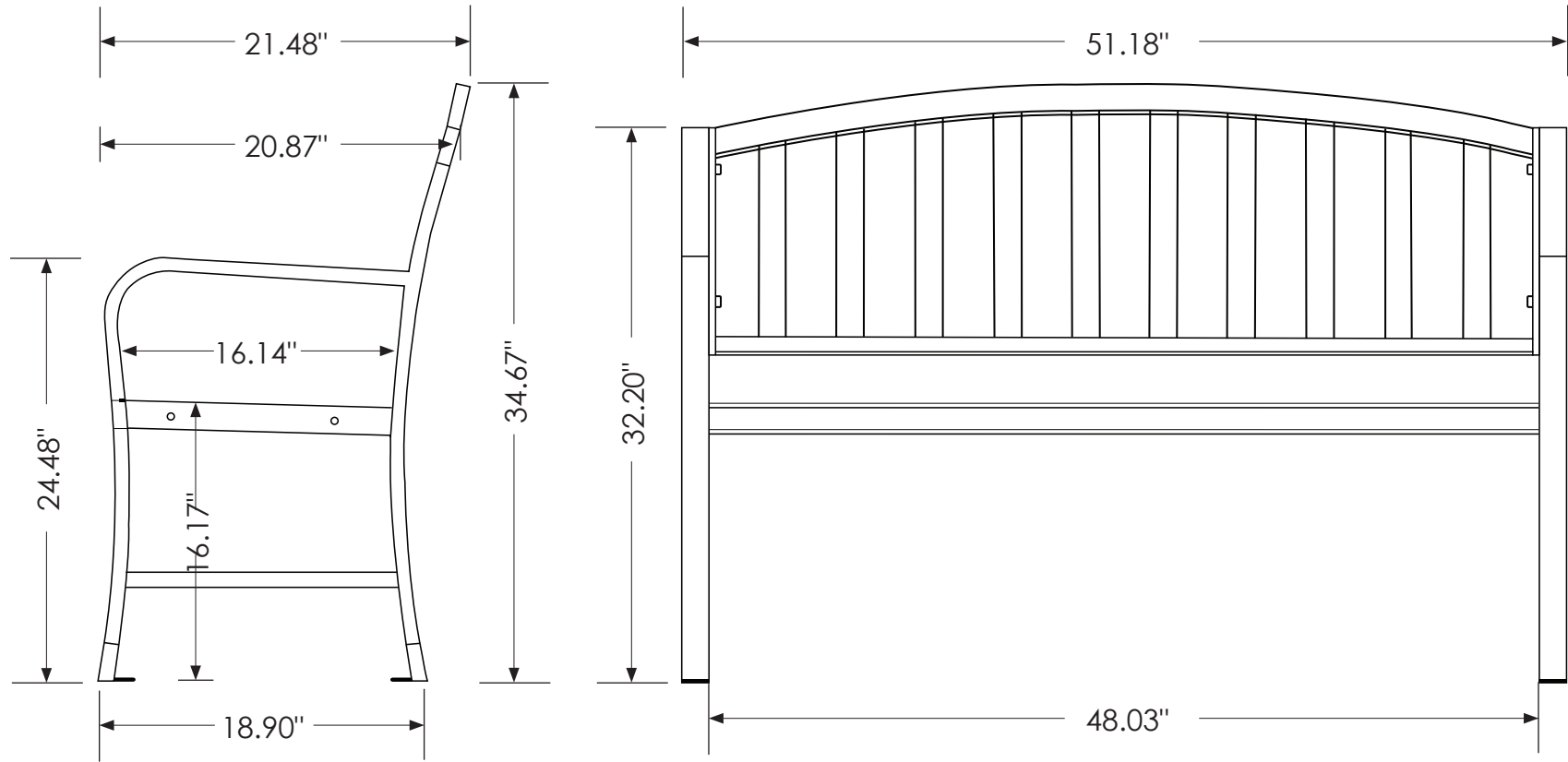

.....
TOTAL WEIGHT: 31 lbs
.....

- NOTES:**
- 1) Material: Extruded aluminum tubes
 - 2) Coating: Powder-coated
 - 3) Black zinc-plated assembly hardware included
 - 4) Surface mount hardware not included

